

# AHD IR DOME CAMERA FIXED LENS

DI-390AHD36



<b>MODEL</b>	<b>DI-390AHD36</b>
Image Sensor	1/3" Sony 2MP Sensor
Effective Pixels	1984(H)×1225(V)
Scanning System	Progressive
Resolution	Digital:1980x1080, Analog:960H
Min. Illumination	0.01Lux
Day & Night	True Day&Night (ICR)
IR LED	2 LED Array (20m)
OSD Menu	Available(11 Languages, AHD/CVBS Output Selectable)
Day & Night Mode	EXT, Color, B&W, Auto
Backlight Compensation	Off/BLC/HSBLC
S/N Ratio	≥72dB (AGC Off)
White Balance	ATW,AWC,Indoor,Outdoor,Manual,AWB
Noise Reduce	3D-DNR For AHD / 2D-DNR For CVBS
Video Output	AHD/CVBS (Signal Selectable from OSD)
Defog	Off/On
Privacy Mask	On/Off (4 Areas)
Motion Detection	On/Off (4 Areas)
D-Effect	Freeze, Mirror, Negative Image
Lens	3.6mm
Power	DC12V±10%, ~310mA
Operation Temp.	-10°C~+50°C
Waterproof	IP66
Dimension	104*70.8*93.2mm
Net weight	270g

## Main Features:

Sensor: 1/3" Sony, 2 Mega-Pixel  
 Selectable output-1080P AHD/Analog  
 Lens: 3.6mm Mega-Pixel Fixed  
 True Day & Night – ICR  
 IR Range: 20m (2 Array LED)  
 IP66  
 Weight: 270g  
 Power: DC 12V, ~310mA



Junction Box (PR-B30JB)  
is available

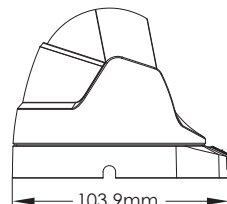
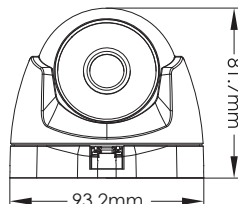

OSD Controller