

# HD ANALOG IR DOME CAMERA VARI-FOCAL LENS

DI-280AMVF



MODEL	DI-280AVF
Image Sensor	1/2.5" CMOS
Image Format	8MP - 16:9 / 5MP - 4:3 / 4MP - 16:9 / 2MP - 16:9
Effective Pixels	3864(H)×2202(V)
Scanning System	Progressive
Resolution	8MP: 3840x2160 @ 15FPS, 5MP:2592x1944 @ 20FPS, 4MP: 2560x1440, @ 25FPS, 2MP@25/30FPS, CVBS@25/30FPS
Min. Illumination	0.1Lux (0 Lux with IR on)
Day & Night	True Day&Night (ICR)
IR LED	3 LED Array (25m)
OSD Menu	Available via CoC Only
CoC Support	Yes
Day & Night Mode	EXT, Color, B&W
Backlight Compensation	Off / BLC
S/N Ratio	≥50dB (AGC Off)
White Balance	ATW, Manual
Noise Reduce	3D-DNR
Video Output	8MP / 5MP / 4MP / 2MP (Selectable by OSD Menu) AHD/TVI/CVI (4MP Only)/ CVBS + PAL/NTSC (Selectable by DIP Switch on cable)
Defog	Not Available
Privacy Mask	Not Available
Motion Detection	Not Available
D-Effect	Mirror
Lens (Field of View)	2.7-13.5mm Motorized VF with Auto Focus - Control over CoC only
Power	DC12V±10%, ~360mA
Operation Temp.	-30°C~+50°C
Waterproof	IP66
Dimension	129.5*119*104mm
Net weight	476g

## Main Features:

Sensor: 1/2.5", 8 Mega-Pixel

Selectable Output:

8MP: AHD / CVI / TVI

5MP: AHD / TVI

4MP: AHD / CVI / TVI

2MP: AHD / CVI / TVI

CVBS

PAL/NTSC

Lens: 2.7-13.5mm Motorized VF with Auto

Focus

True Day & Night – ICR

IR Range: 25m (3 Array LED)

IP66

CoC Support

Weight: 476g

Power: DC 12V, ~360mA



Junction Box (PR-B47JB)  
is available

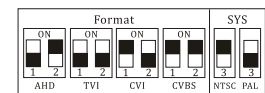
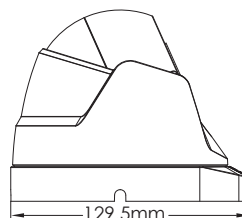
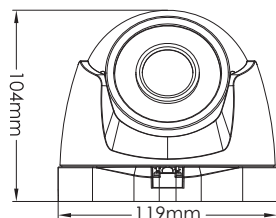

DIP Switch for Output Selection